

ER200 Series shown with Hardwood Base (ER200HW)

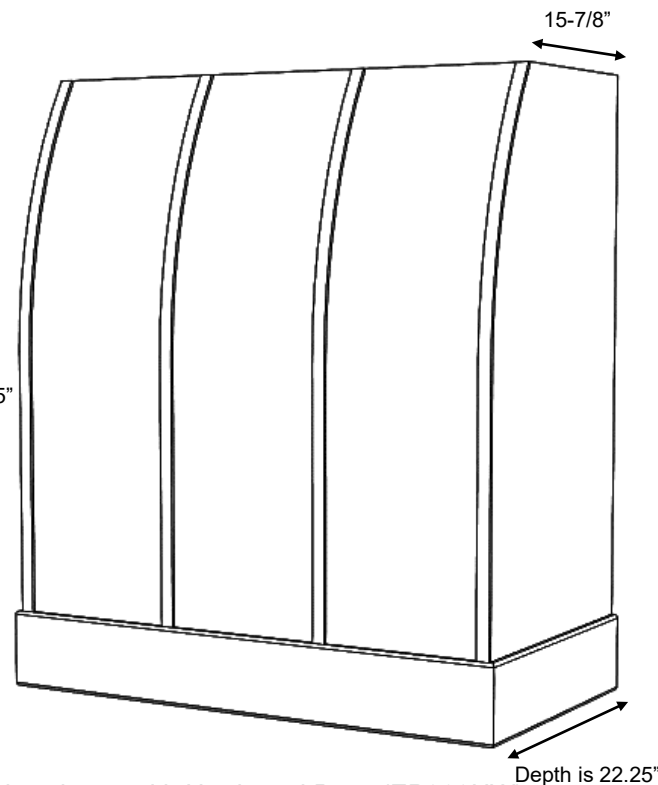

ER200 Series shown with Hardwood Base (ER200HW) and optional Hardwood Battens

### ER200 Series

Standard Widths	30, 36, 42, 48, 54, 60 (Reduced widths available)
Standard Heights	30, 36, 42, 48, 54, 60 (Reduced heights available)
Removable Options	Not available
Available Options	Hardwood Battens (See batten options page)
Ventilation	Hood will be same width as available vent width. Example: To use a 36" vent model, the hood should be a minimum of 36" wide.
Grain Direction	Vertical (base is horizontal)

Standard Heights: 30, 36, 42, 48, 54, 60

#### ER200- Hardwood Base

- ER200HW 30
- ER200HW 36
- ER200HW 42
- ER200HW 48
- ER200HW 54\*
- ER200HW 60\*

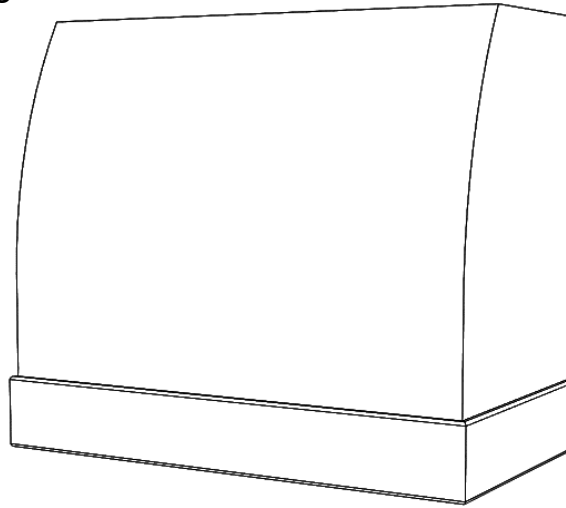

#### ER200- SS Base

- ER200SS 30
- ER200SS 36
- ER200SS 42
- ER200SS 48
- ER200SS 54\*
- ER200SS 60\*

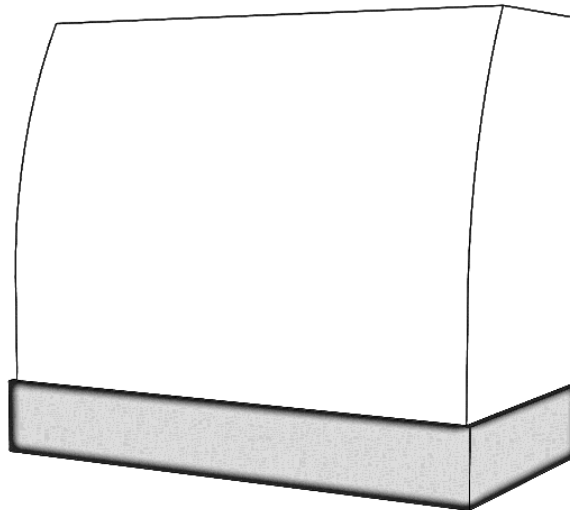

\* Hoods over 48" Wide have a maximum height of 48".

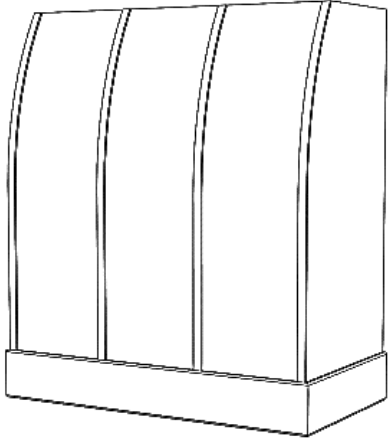

*ER200 Series shown with Hardwood Base (ER200HW)  
and optional battens*

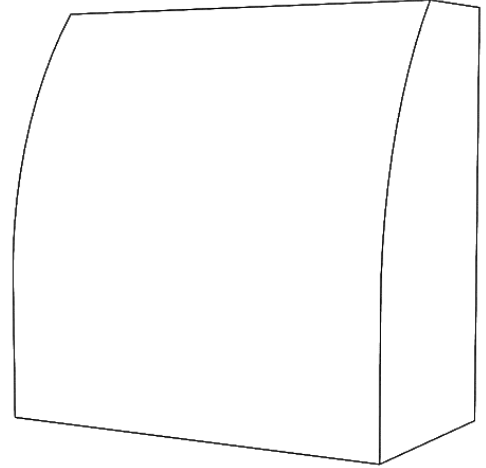

*ER300 Series hood (ER300)*

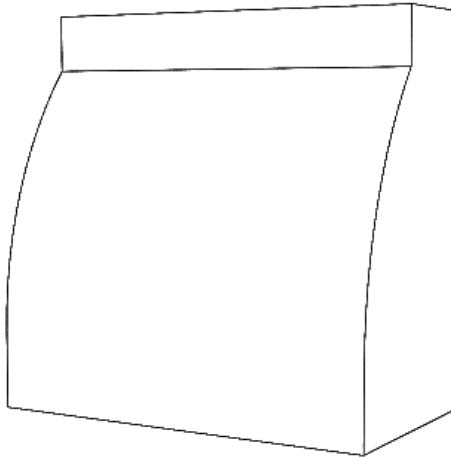

*ER400 Series hood (ER400)*

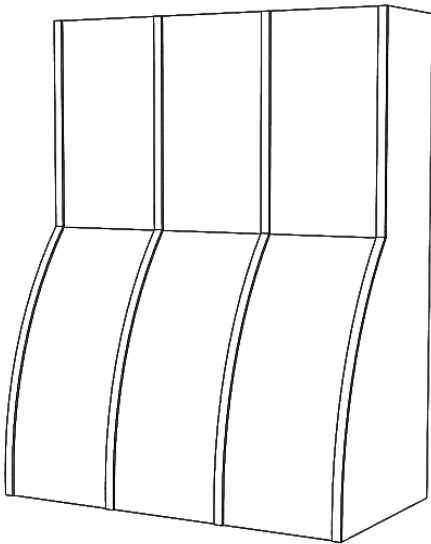

*ER500 Series hood (ER500)  
shown with optional battens*

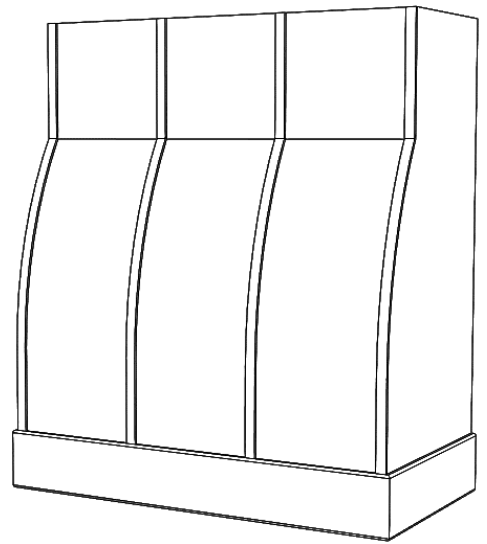

*ER600 Series hood shown with hardwood base (ER600HW)  
and optional battens on curved face*

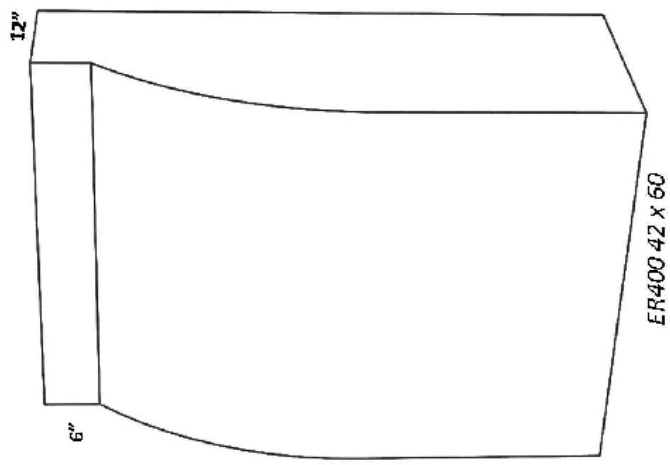

**ER400**  
In-Series

**ER600**  
Free-Standing

FOR OVERALL HEIGHT: 42 - 60"

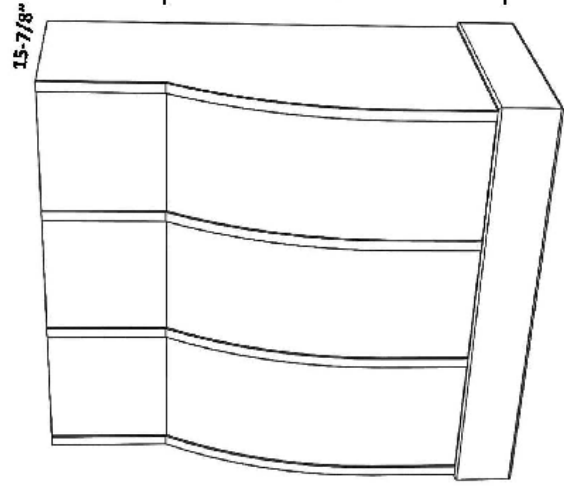

ER600 shown with hardwood base (ER600HW) and optional battens

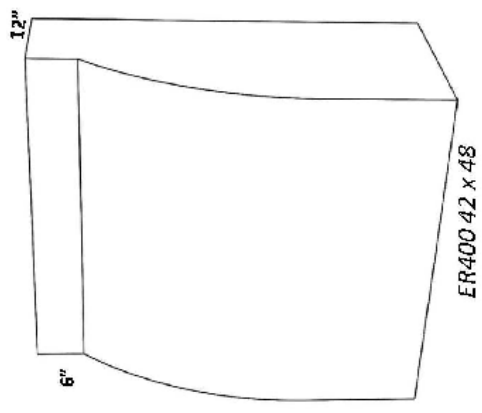

**ER300**  
In-Series

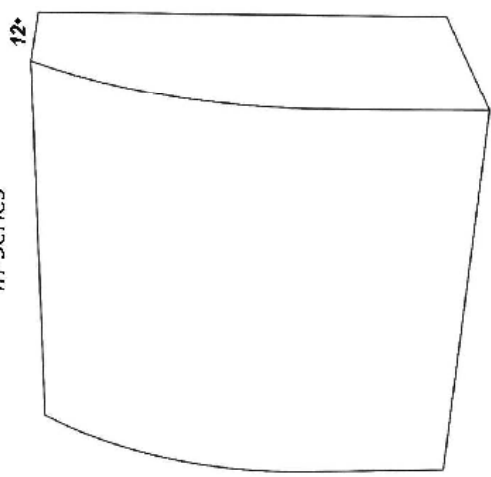

FOR OVERALL HEIGHT: 36"

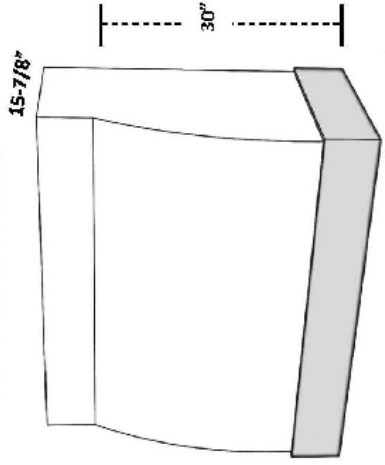

ER600 shown with SS Base (ER600SS)

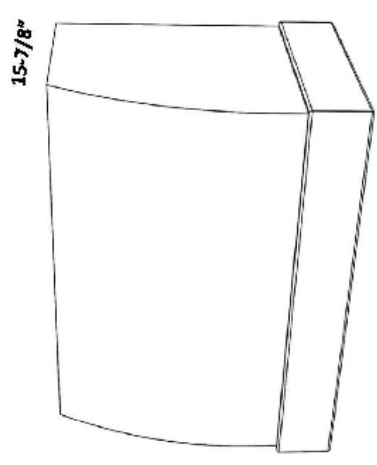

ER200 shown with hardwood base (ER200HW)

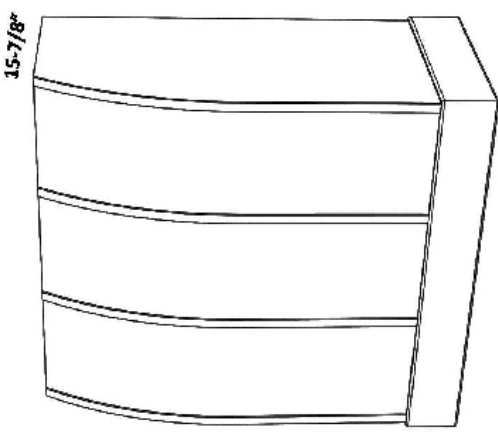

ER200 shown with hardwood base (ER200HW) and optional battens

**ER200**  
Free-Standing

**ER500**  
In-Series

FOR OVERALL HEIGHT: 42 - 60"

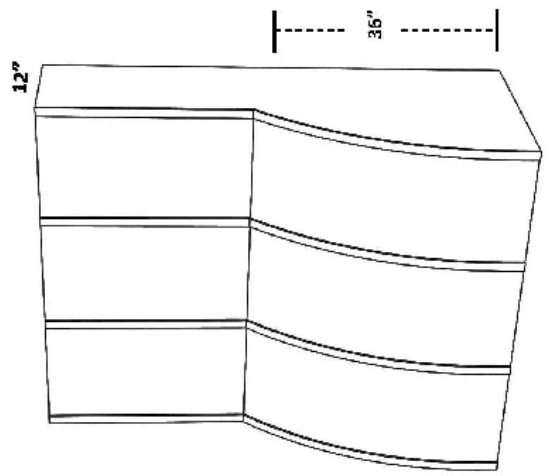

ER500 Series hood (ER500) Shown with optional battens

FOR OVERALL HEIGHT: 36"

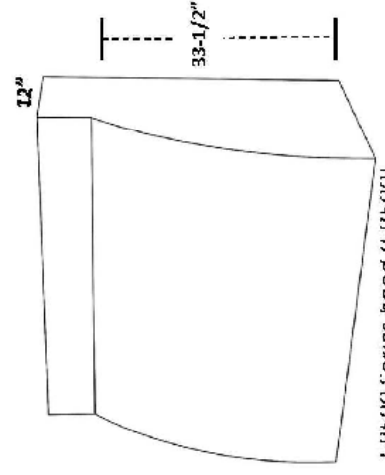

ER500 Series hood (ER500)