

*ER300 Series Hood (ER300)*

**ER300 Series**

Standard Widths	30, 36, 42, 48, 54, 60 (Reduced widths available)
Standard Heights	36, 42, 48, 54, 60 (Reduced heights available)
Removable Options	Not available
Available Options	Hardwood Battens (See batten options page)
Ventilation	Hood will be same width as available vent width. Example: To use a 36" vent model, the hood should be a minimum of 36" wide.
Grain Direction	Vertical

700 South Gaspie Street • Oxford, MI 48371 • (248) 572-6880 • email: sales@wood-hood.com • [www.wood-hood.com](http://www.wood-hood.com)

Standard Heights: 36, 42, 48, 54, 60

ER300

ER300 30  
ER300 36  
ER300 42  
ER300 48  
ER300 54\*  
ER300 60\*

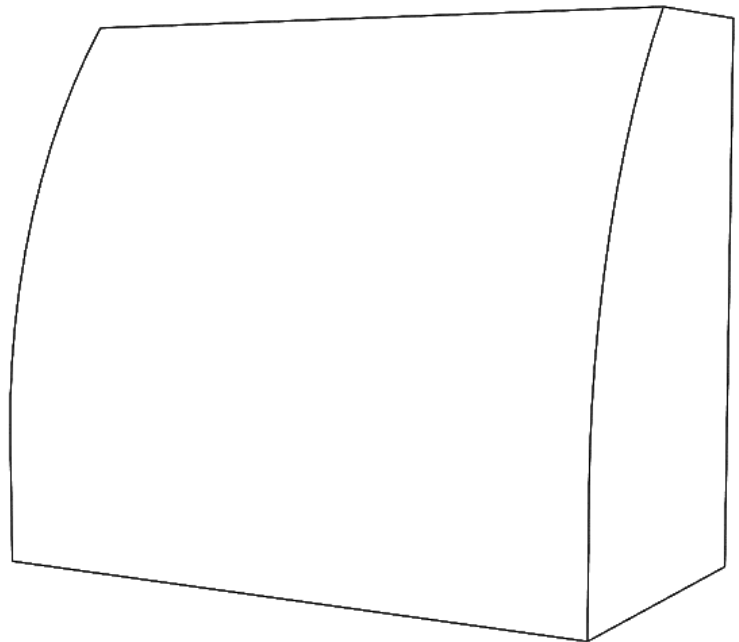

*\* Hoods over 48" Wide have a maximum height of 42"*

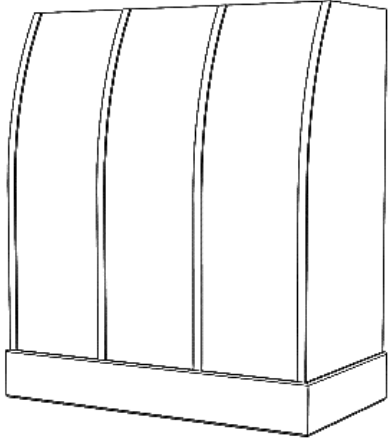

*ER200 Series shown with Hardwood Base (ER200HW)  
and optional battens*

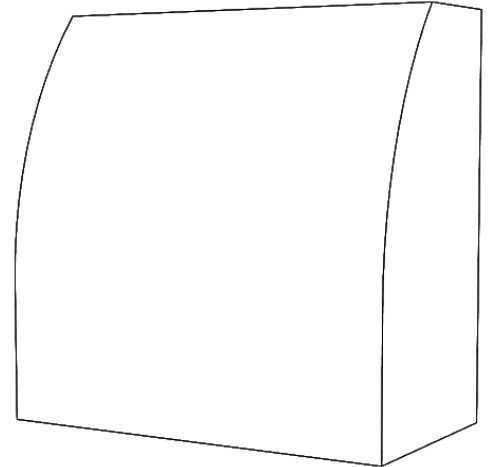

*ER300 Series hood (ER300)*

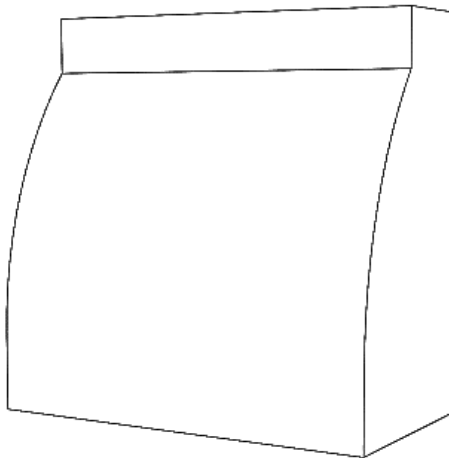

*ER400 Series hood (ER400)*

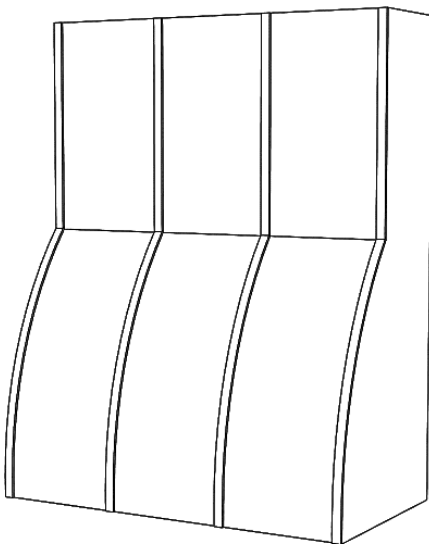

*ER500 Series hood (ER500)  
shown with optional battens*

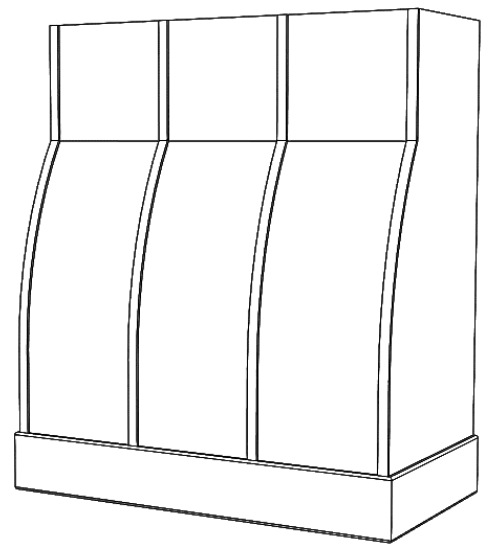

*ER600 Series hood shown with hardwood base (ER600HW)  
and optional battens on curved face*

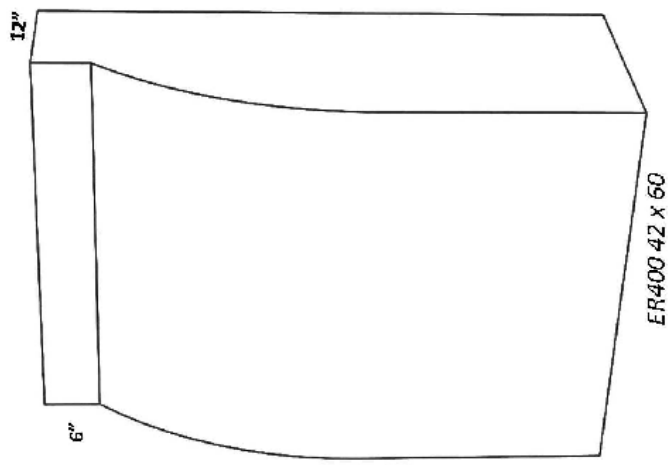

**ER400**  
In-Series

**ER600**  
Free-Standing

FOR OVERALL HEIGHT: 42 - 60"

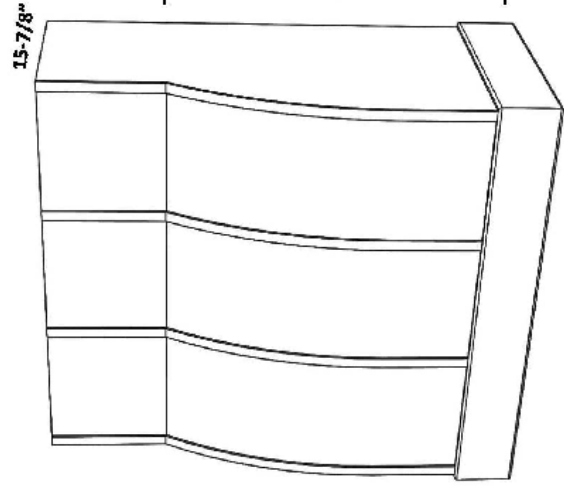

ER600 shown with hardwood base (ER600HW) and optional battens

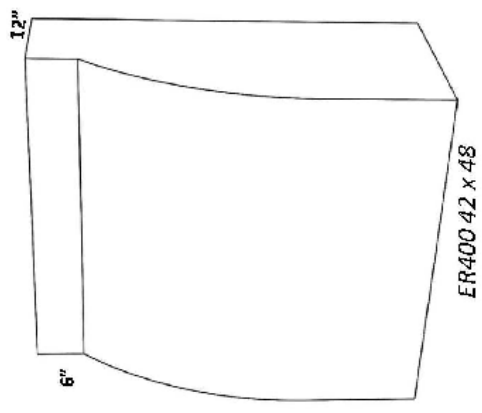

**ER300**  
In-Series

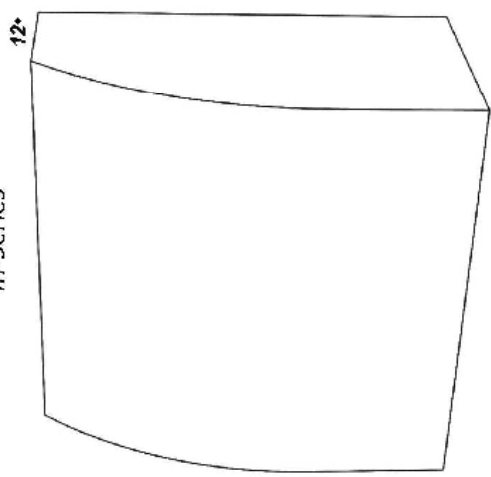

FOR OVERALL HEIGHT: 36"

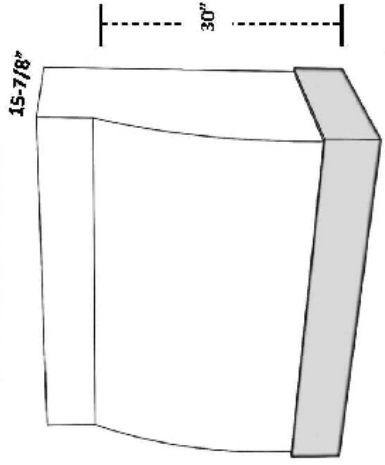

ER600 shown with SS Base (ER600SS)

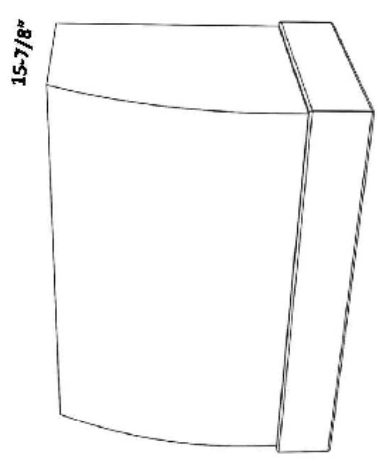

ER200 shown with hardwood base (ER200HW)

FOR OVERALL HEIGHT: 36"

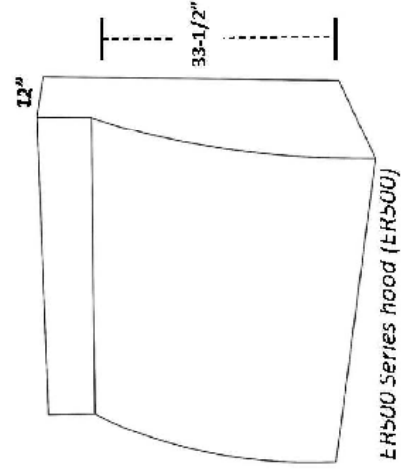

ER500 Series hood (ER500)

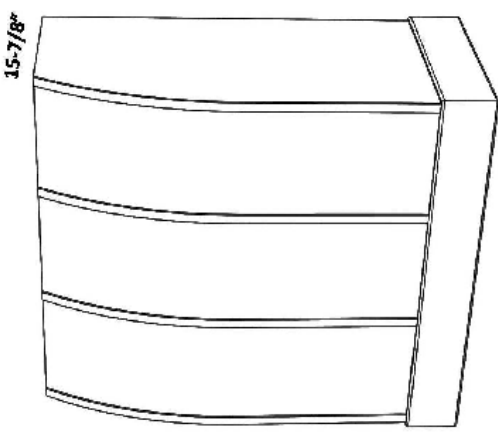

ER200 shown with hardwood base (ER200HW) and optional battens

**ER200**  
Free-Standing

**ER500**  
In-Series

FOR OVERALL HEIGHT: 42 - 60"

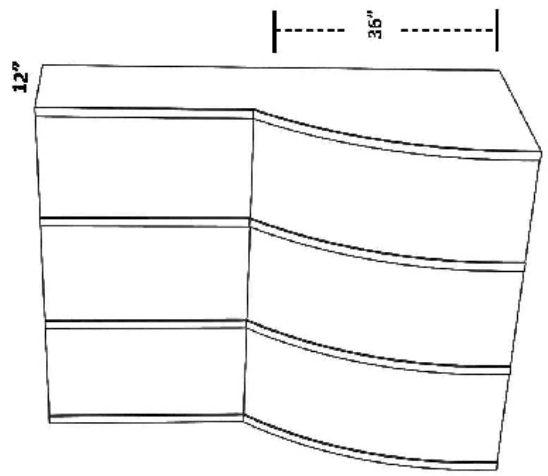

ER500 Series hood (ER500) Shown with optional battens