

FOR OVERALL HEIGHTS: 48" – 60"

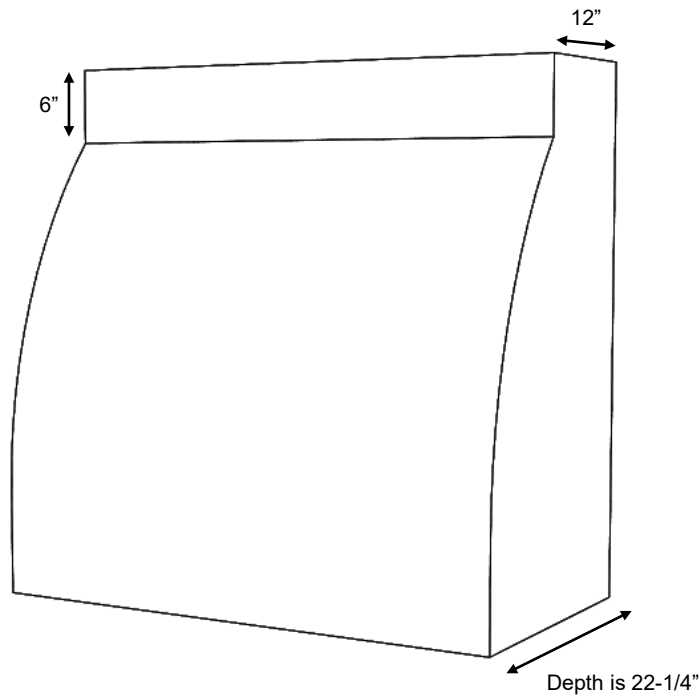

*ER400 Series Hood, 42 x 48 (ER400)*

**ER400 Series**

Standard Widths	30, 36, 42, 48, 54, 60 (Reduced widths available)
Standard Heights	48, 54, 60 (Reduced heights available)
Removable Options	Not available
Available Options	Hardwood Battens (See batten options page)
Ventilation	Hood will be same width as available vent width. Example: To use a 36" vent model, the hood should be a minimum of 36" wide.
Grain Direction	Vertical

Standard Heights: 48, 54, 60

ER400

ER400 30

ER400 36

ER400 42

ER400 48

ER400 54\*

ER400 60\*

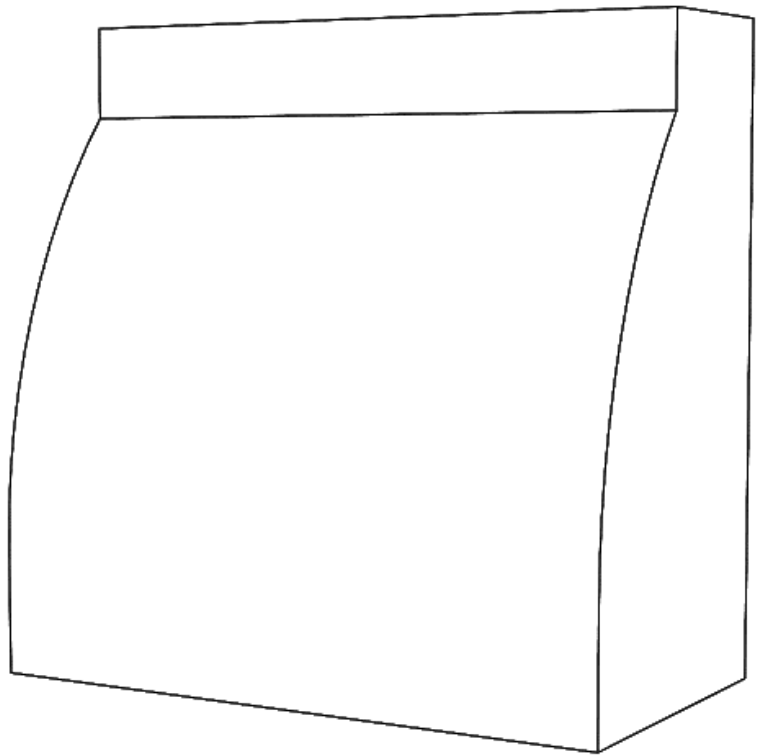

*\* Hoods over 48" Wide have a maximum height of 48"*

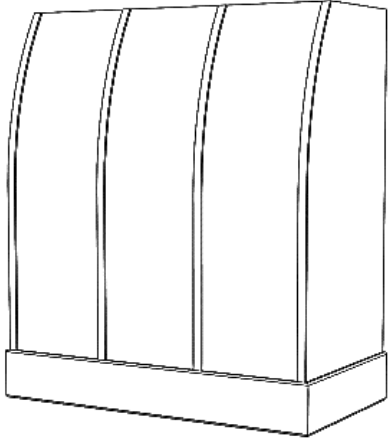

*ER200 Series shown with Hardwood Base (ER200HW)  
and optional battens*

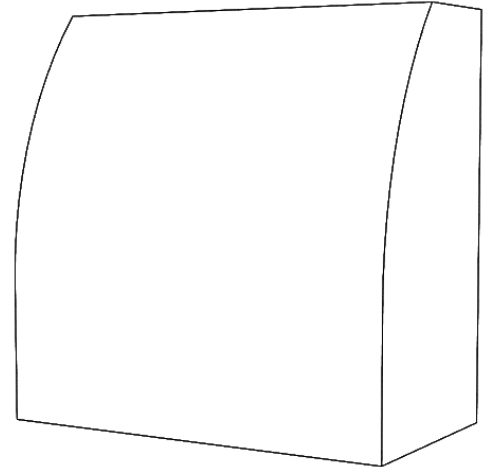

*ER300 Series hood (ER300)*

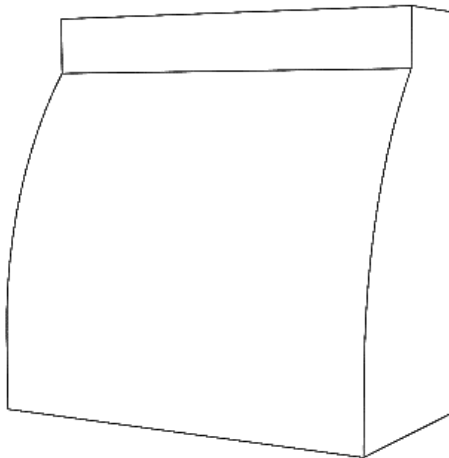

*ER400 Series hood (ER400)*

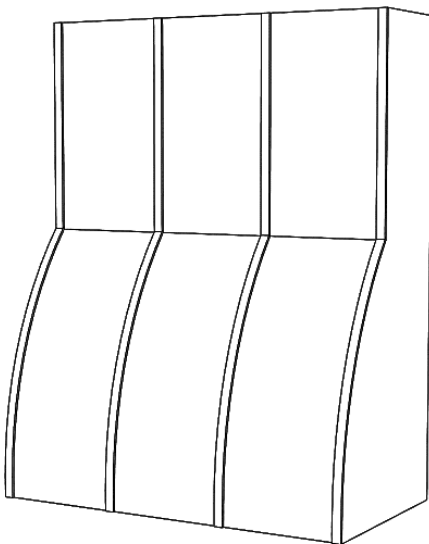

*ER500 Series hood (ER500)  
shown with optional battens*

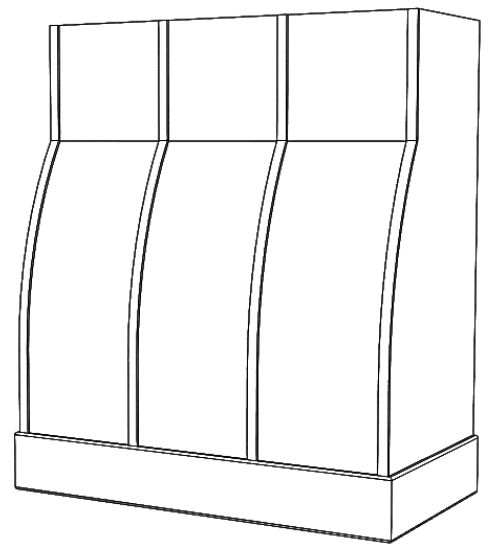

*ER600 Series hood shown with hardwood base (ER600HW)  
and optional battens on curved face*

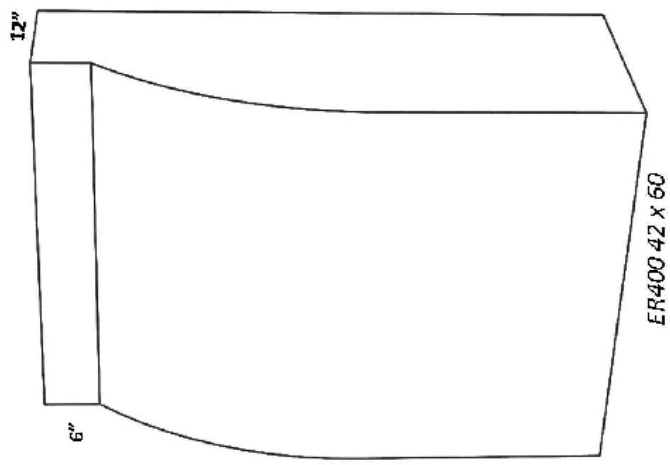

**ER400**  
In-Series

**ER600**  
Free-Standing

FOR OVERALL HEIGHT: 42 - 60"

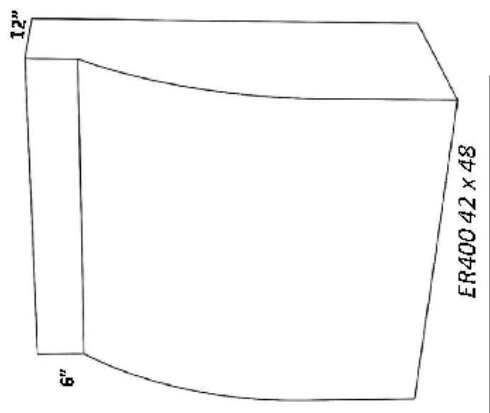
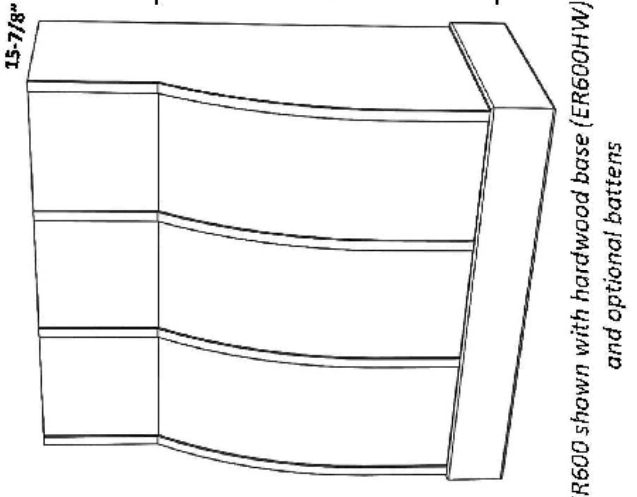

**ER300**  
In-Series

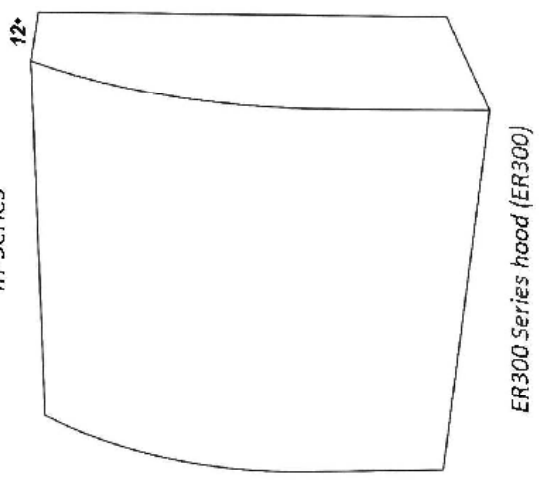

FOR OVERALL HEIGHT: 36"

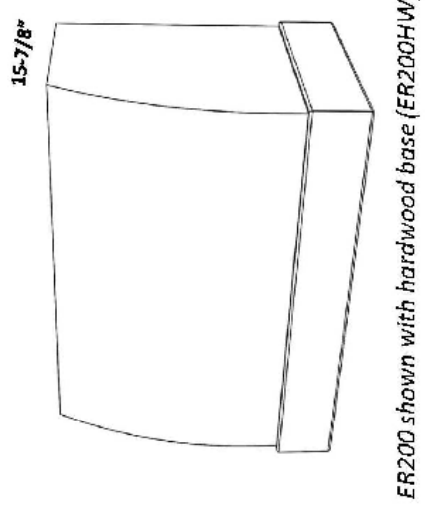
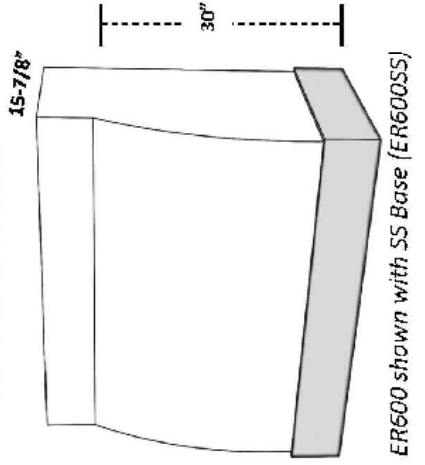

**ER200**  
Free-Standing

**ER500**  
In-Series

FOR OVERALL HEIGHT: 42 - 60"

FOR OVERALL HEIGHT: 36"

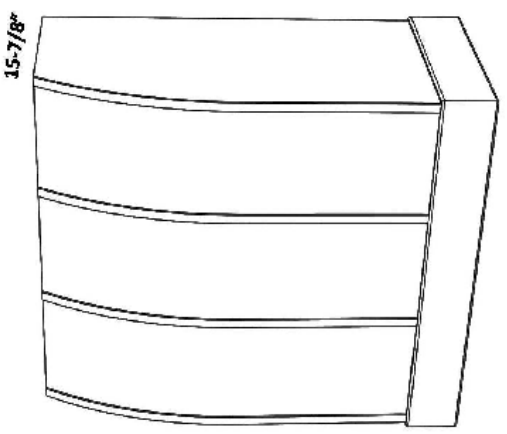
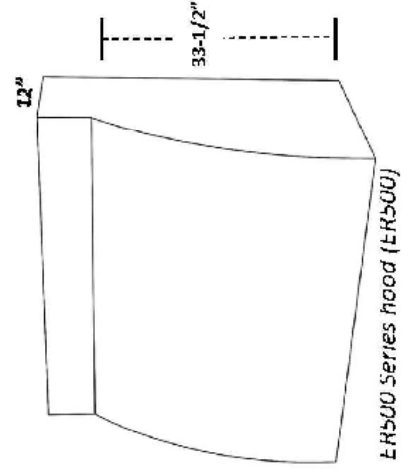

**ER200** shown with hardwood base (ER200HW) and optional battens

